

Euro Roof Eurospan

Scale 1:2

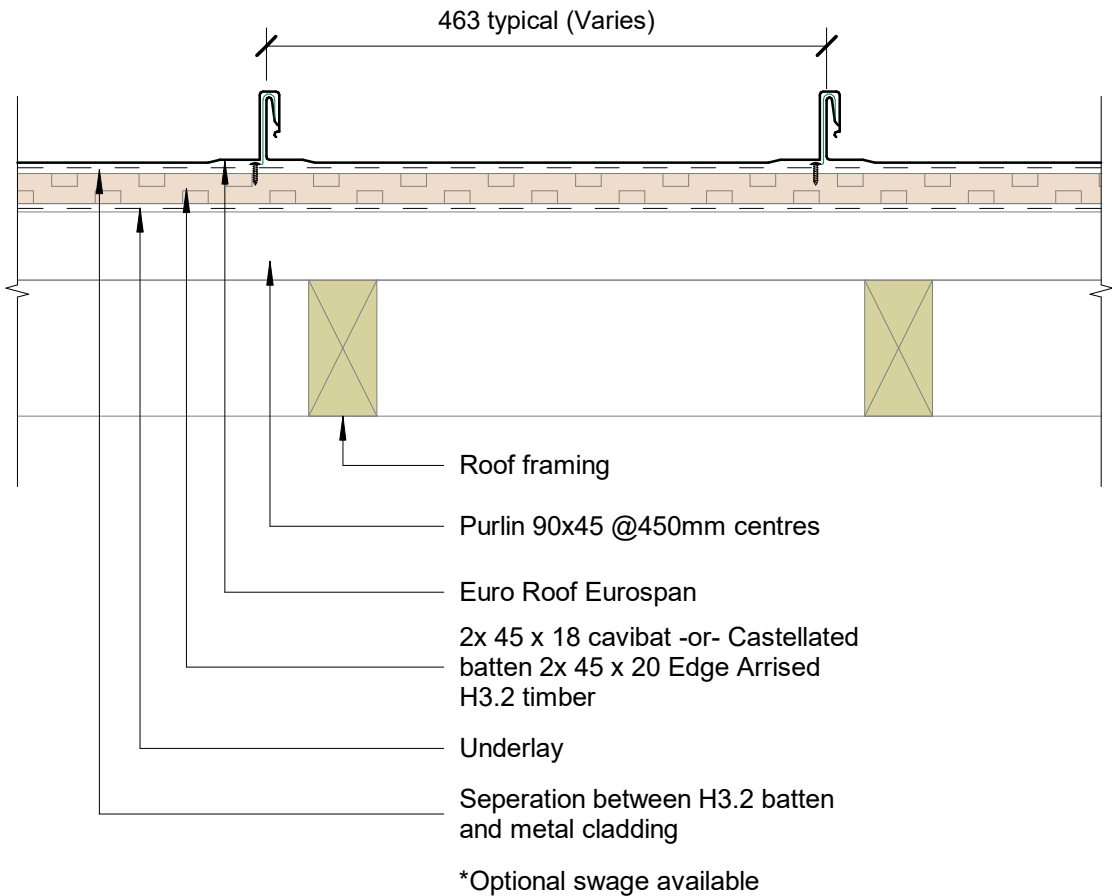

Scale 1:5

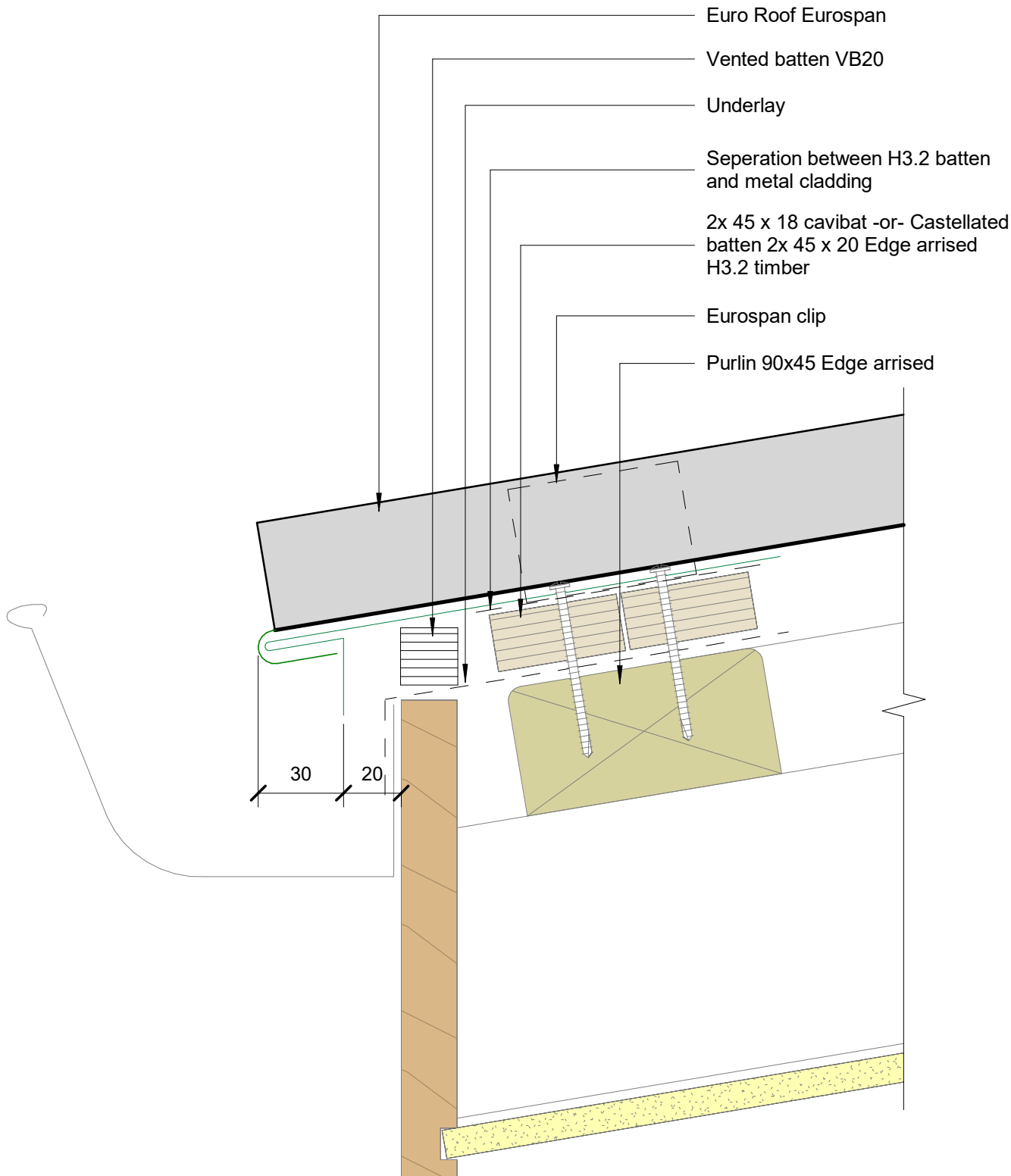

Continuous clip / cleat for flashing
fixing

Roof framing

2x 45 x 18 cavibat -or- Castellated
batten 2x 45 x 20 Edge arrised
H3.2 timber

Eurospan clip

Purlin 90x45 Edge arrised

Ridge flashing to suit

Euro Roof Eurospan

Underlay

Seperation between H3.2 batten
and metal cladding

Fold up ends of roofing pan
troughs. Stop ends short by 5mm

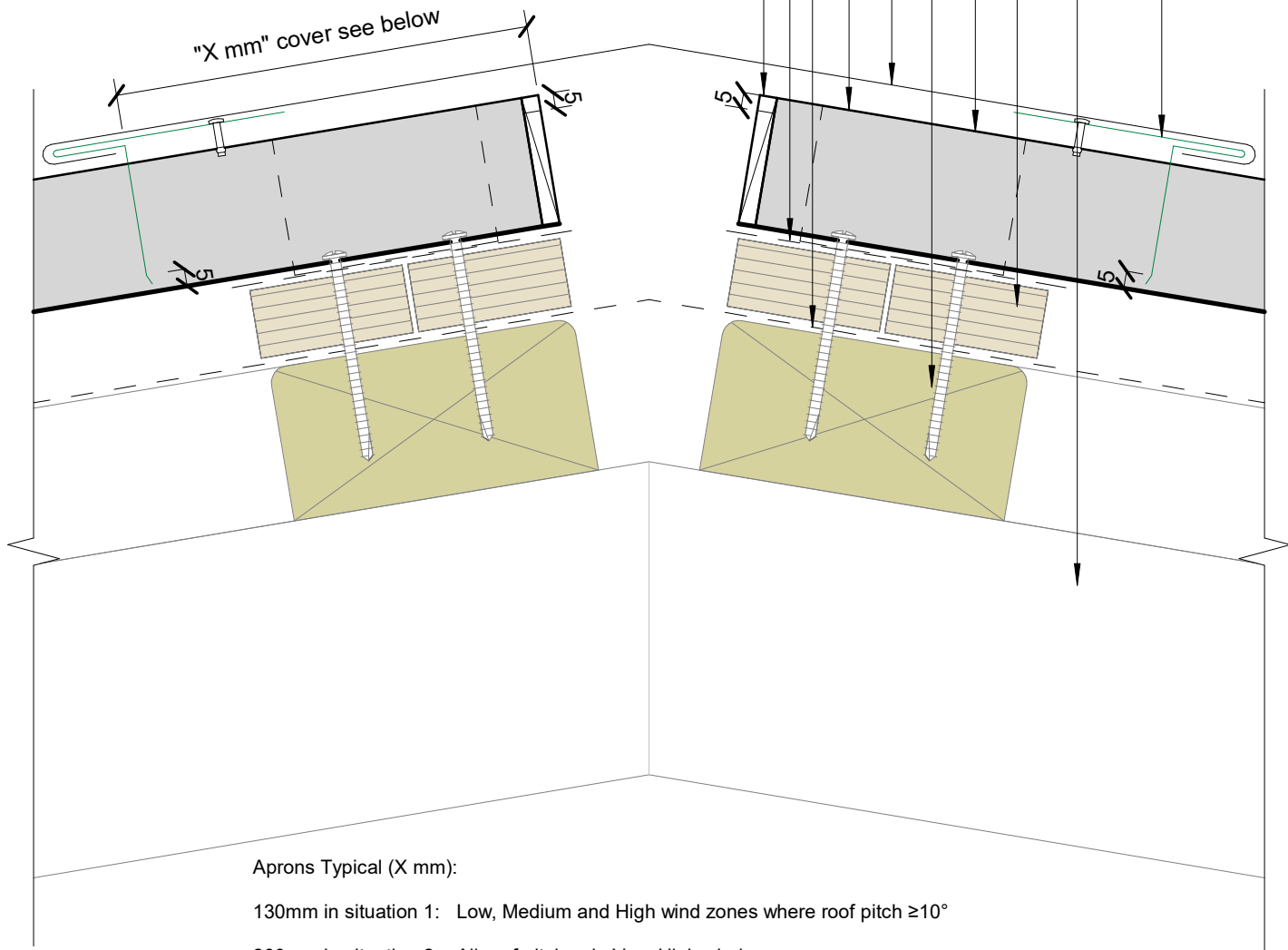

Aprons Typical (X mm):

130mm in situation 1: Low, Medium and High wind zones where roof pitch $\geq 10^\circ$

200mm in situation 2: All roof pitches in Very High wind zones
Low, Medium and High wind zones where roof pitch $\leq 10^\circ$

200mm in situation 3: All roof pitches in Extra High wind zones

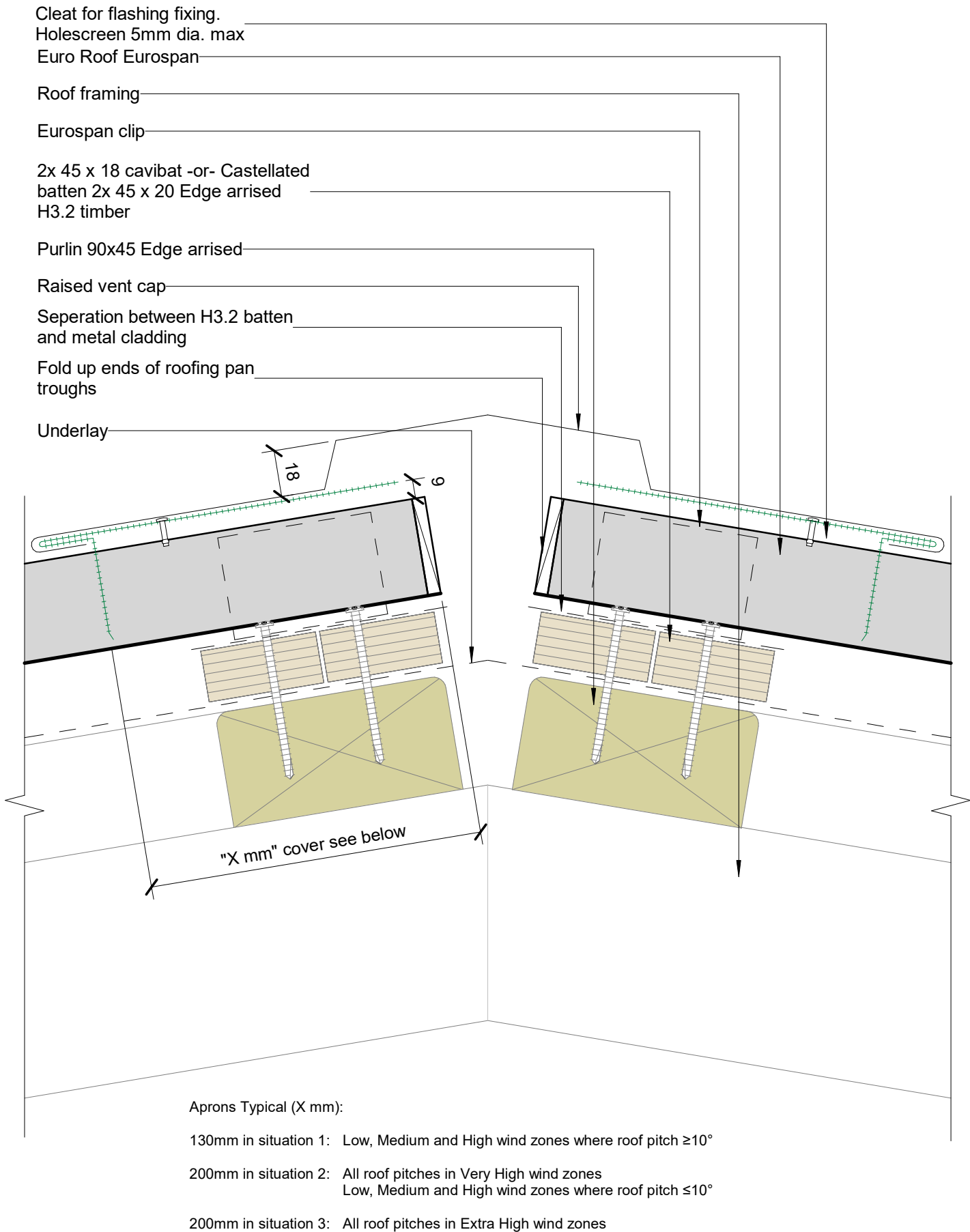



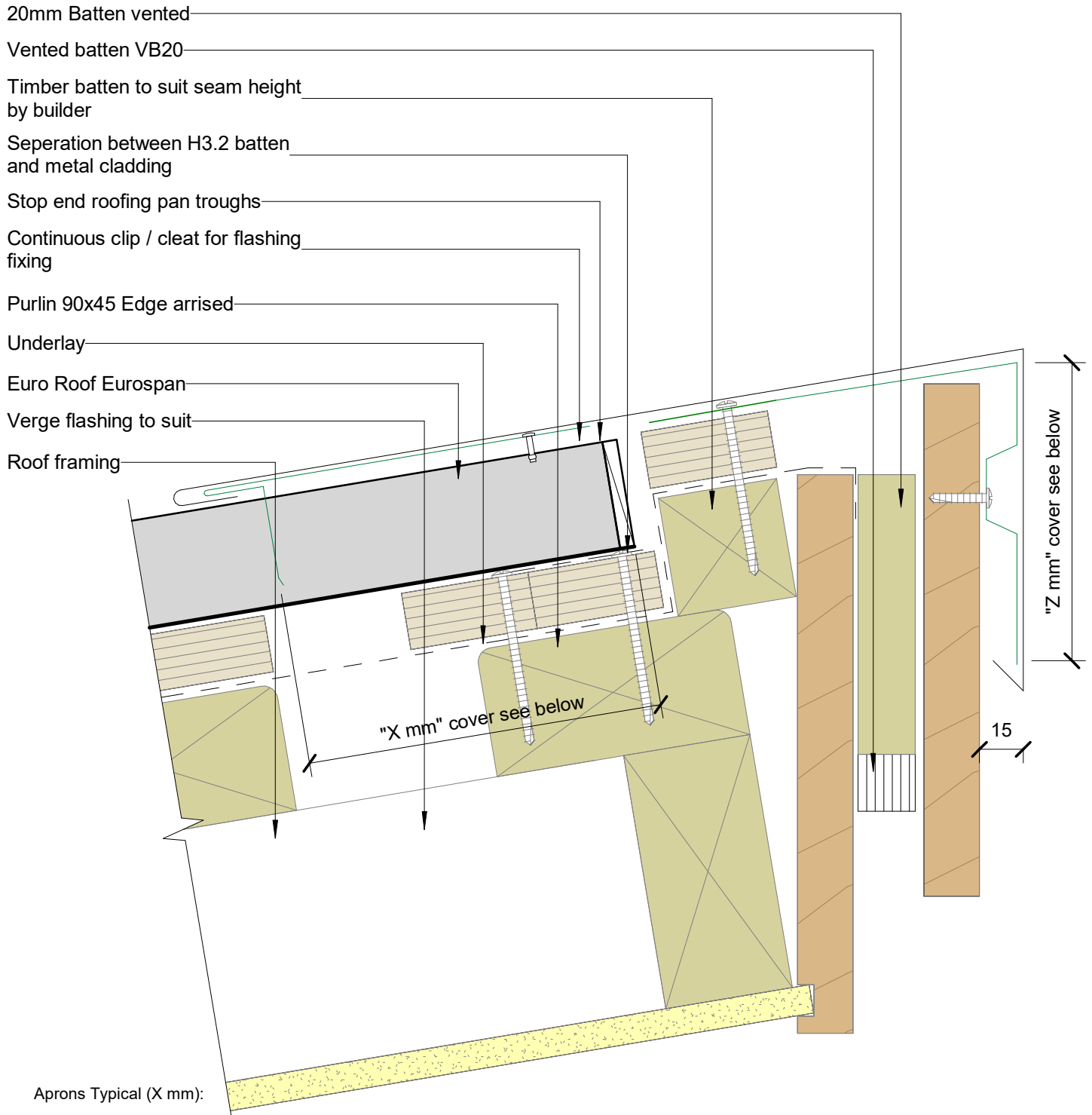

Aprons Typical (X mm):

130mm in situation 1: Low, Medium and High wind zones where roof pitch $\geq 10^\circ$

200mm in situation 2: All roof pitches in Very High wind zones
Low, Medium and High wind zones where roof pitch $\leq 10^\circ$

200mm in situation 3: All roof pitches in Extra High wind zones

Barge Typical (Z mm): excluding drip edge:

50mm in situation 1: Low, Medium and High wind zones where roof pitch $\geq 10^\circ$

70mm in situation 2: All roof pitches in Very High wind zones
Low, Medium and High wind zones where roof pitch $\leq 10^\circ$

90mm in situation 3: All roof pitches in Extra High wind zones

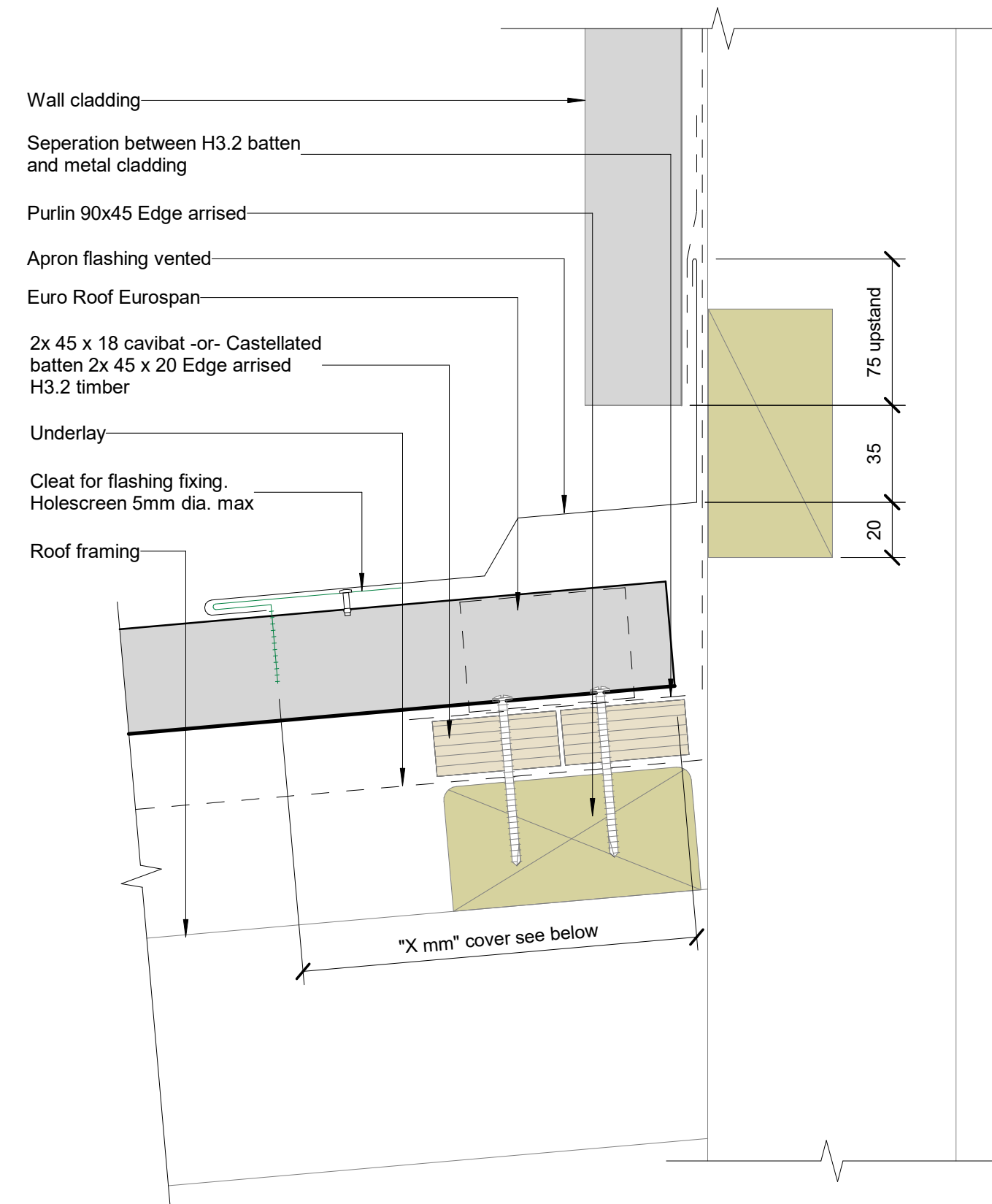

Aprons Typical (X mm):

130mm in situation 1: Low, Medium and High wind zones where roof pitch $\geq 10^\circ$

200mm in situation 2: All roof pitches in Very High wind zones
Low, Medium and High wind zones where roof pitch $\leq 10^\circ$

200mm in situation 3: All roof pitches in Extra High wind zones

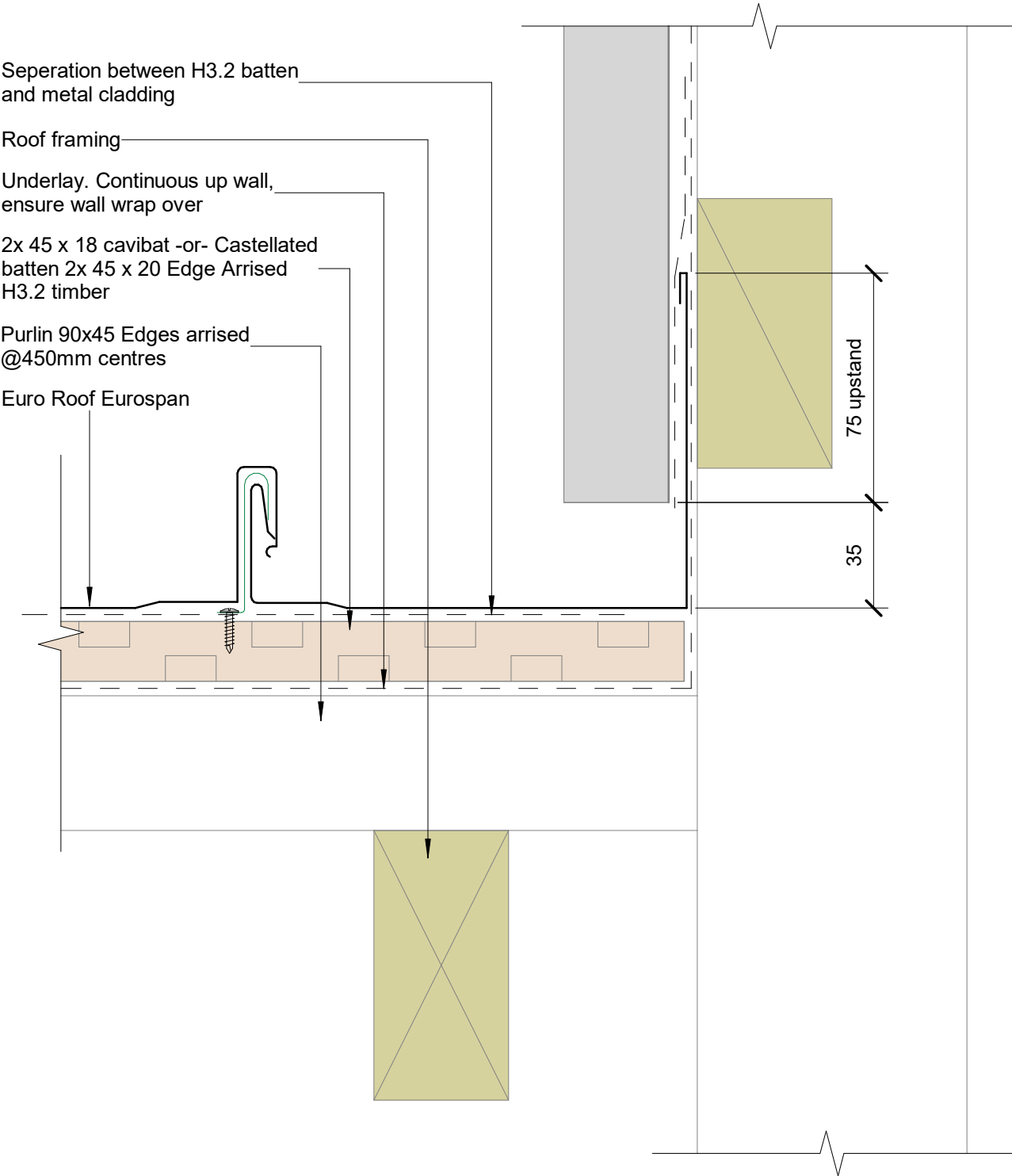

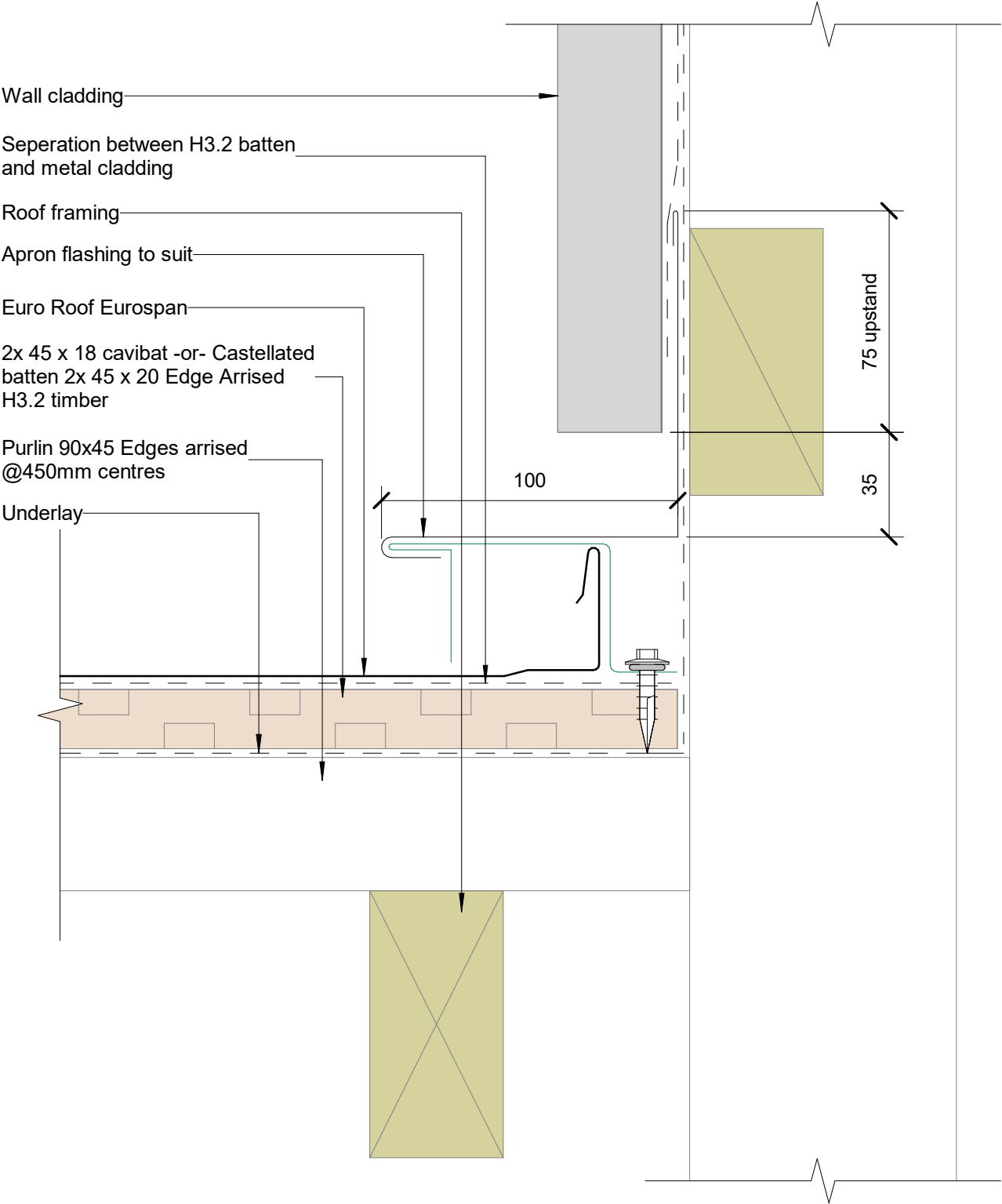

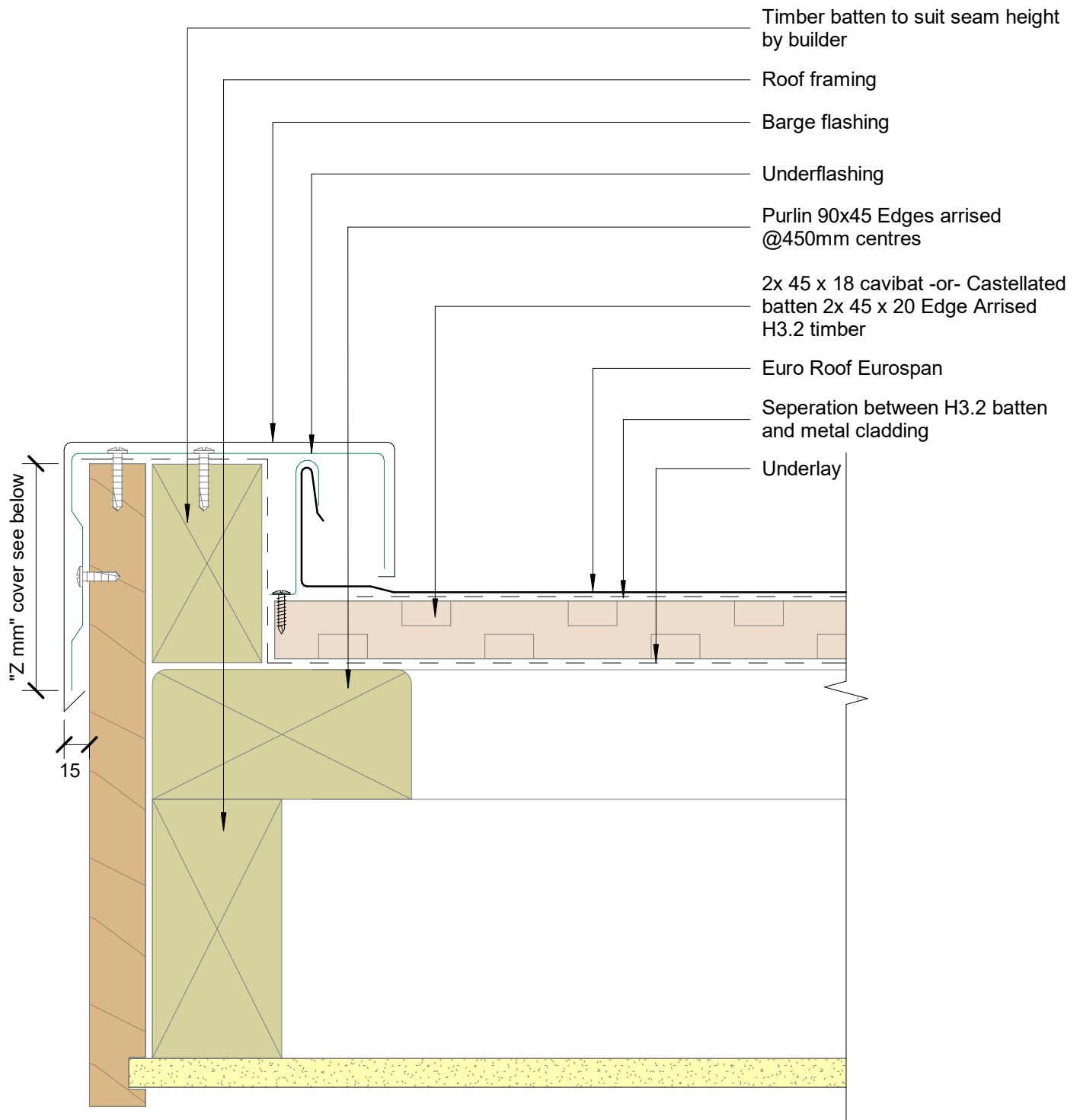

Barge Typical (Z mm): excluding drip edge:

50mm in situation 1: Low, Medium and High wind zones where roof pitch $\geq 10^\circ$

70mm in situation 2: All roof pitches in Very High wind zones
Low, Medium and High wind zones where roof pitch $\leq 10^\circ$

90mm in situation 3: All roof pitches in Extra High wind zones

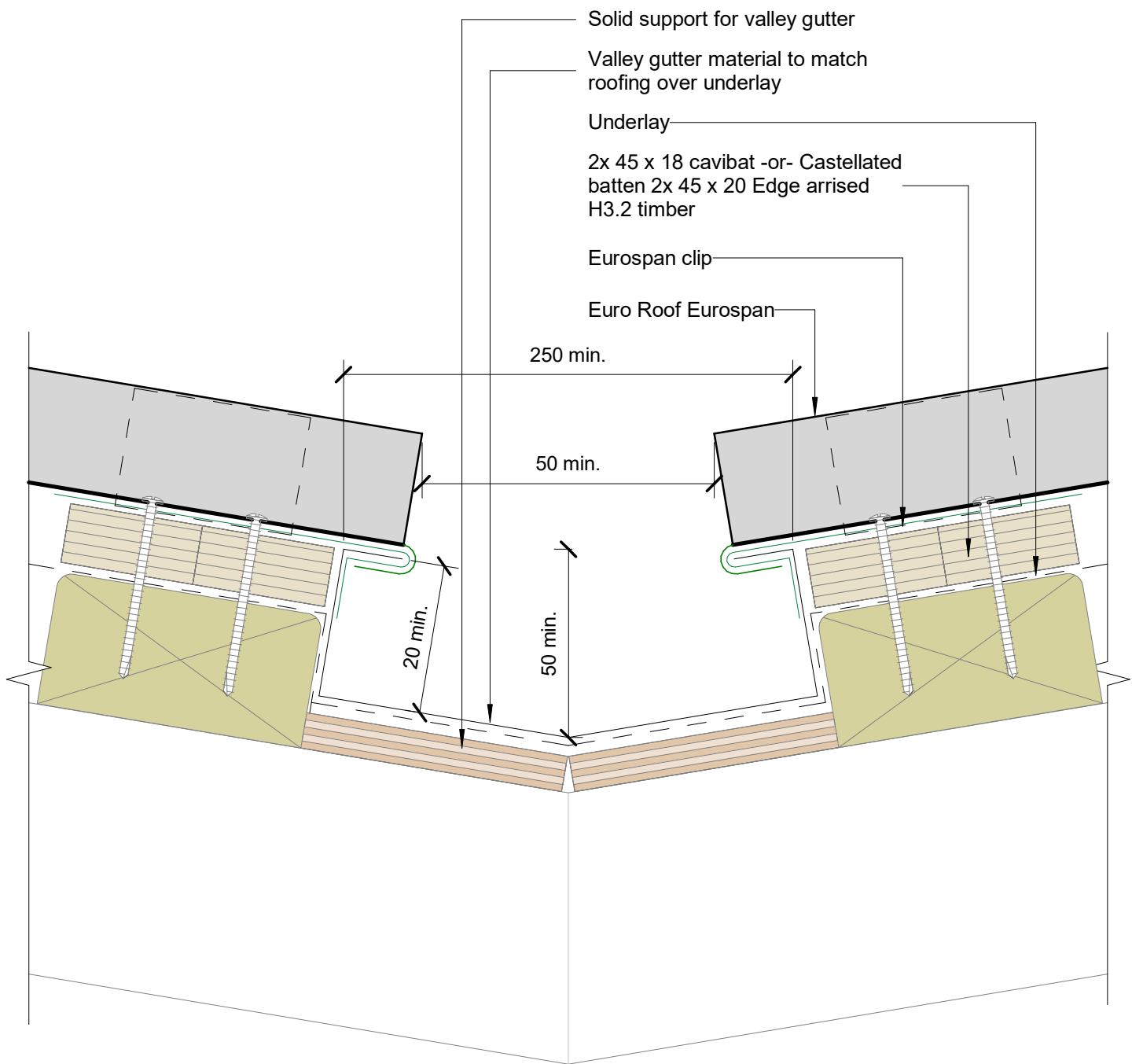

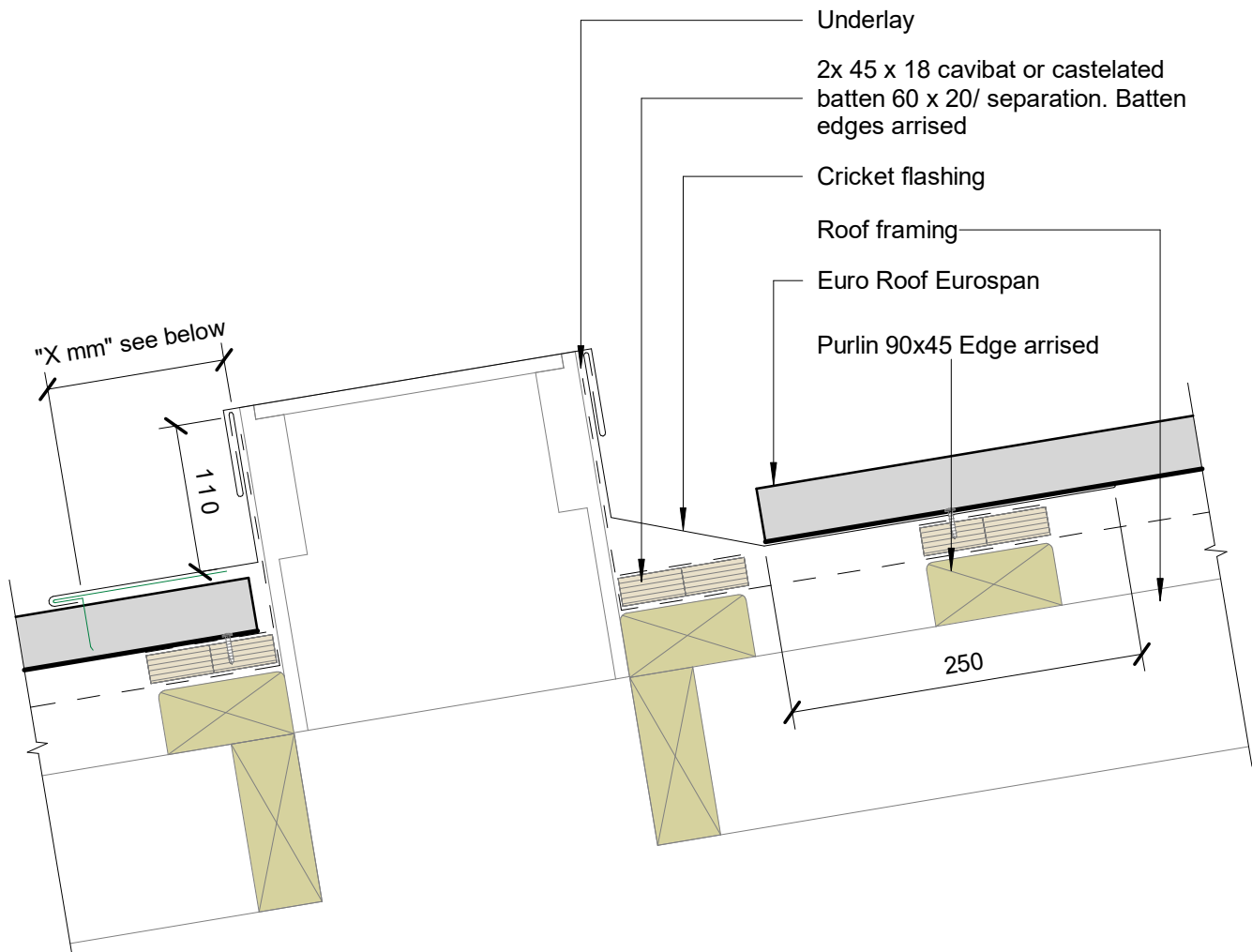

- Aprons Typical (X mm):
- 130mm in situation 1: Low, Medium and High wind zones where roof pitch $\geq 10^\circ$
 - 200mm in situation 2: All roof pitches in Very High wind zones
Low, Medium and High wind zones where roof pitch $\leq 10^\circ$
 - 200mm in situation 3: All roof pitches in Extra High wind zones

